

Installation Guide

1. Accessory

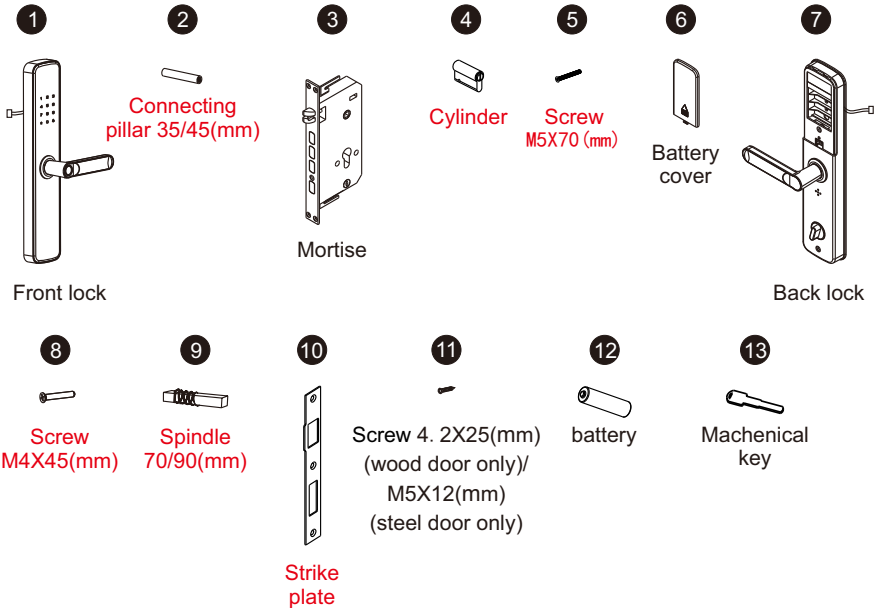

2. Door opening direction

① Right handle opening

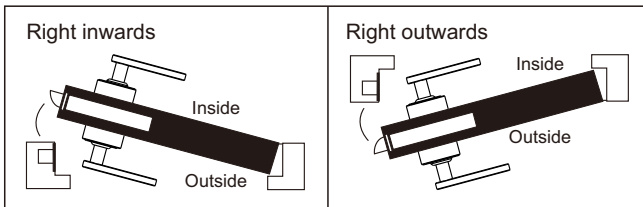

② Left handle opening

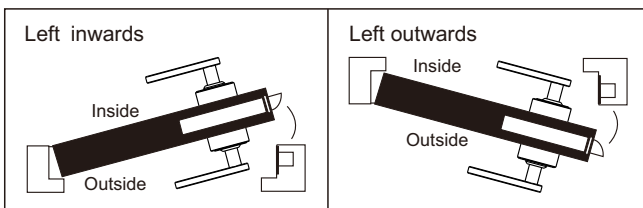

3. Measure the door thickness

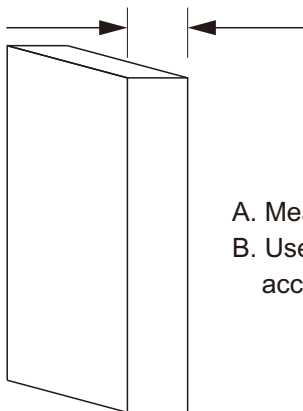

- A. Measure the door thickness.
- B. Use the correct installation kit according to the door thickness.

4. Adjust the L/R opening

Font Panel

- A. Adjust the L/R opening.
- B. Fix the handle by the screw.

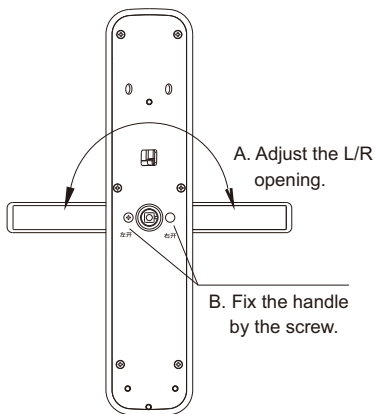

Back Panel

- A. Adjust the L/R opening.
- B. Fix the handle by the screw.

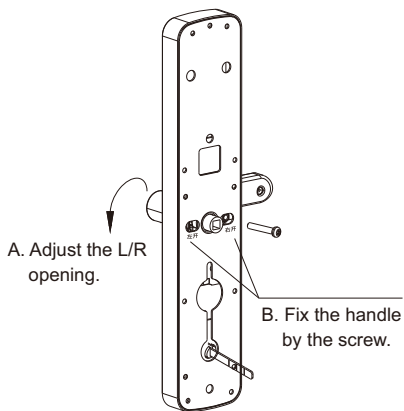

5. Installation overview

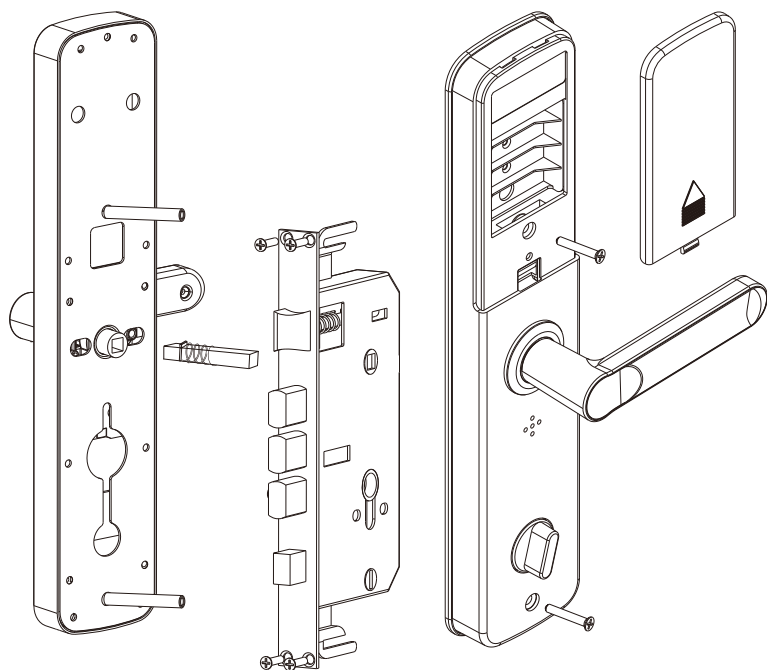

Accessory list		
SN	Name	QTN
1	Cylinder	2
2	Spindle	2
3	Spring	1
4	Screw	2
5	Screw	2
6	Anti-pry stick	1
7	IC card	2
8	Mechanical key	2
9	QC Pass	1

6. Install the mortise

1. Put the mortise into the door hole.
2. Fix the mortise with 4 screws.

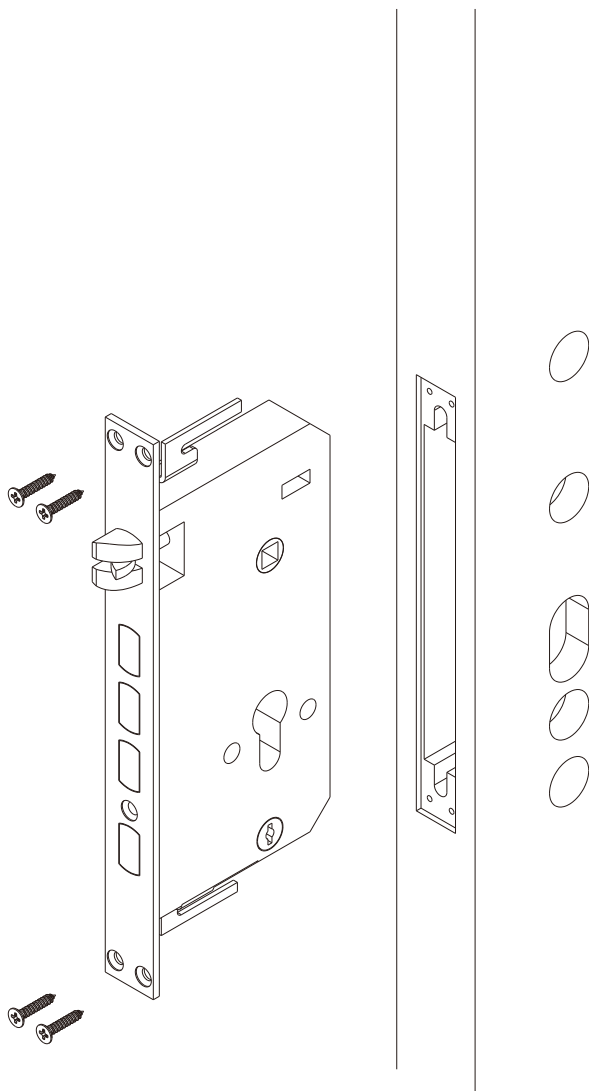

Install the front panel

1. Put the spindle onto the handle.
2. Get the front panel attached to the door.

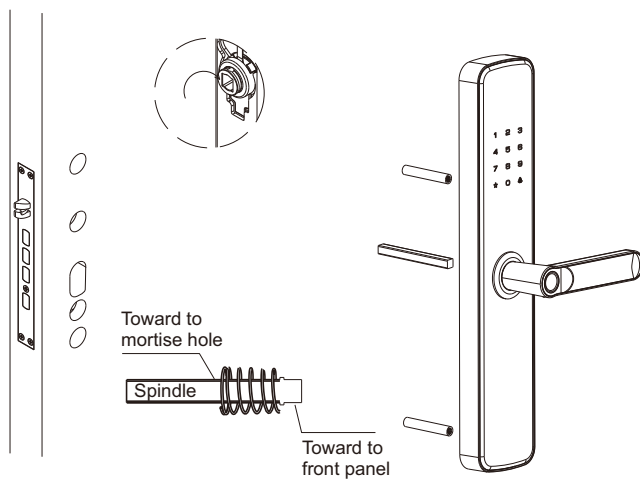

Connect Power cable

1. Connect the cable from front panel to back panel.

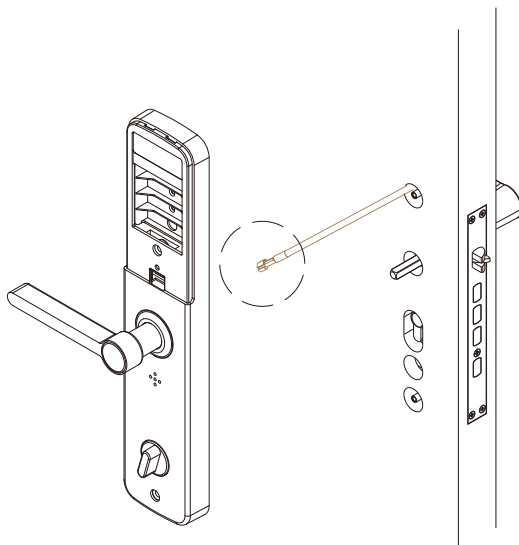

Install the back panel

1. Make sure all the spindles on the correct positions.
2. Make sure the knob pin inert to the mortise hole.
3. Fix the back panel with 2 screws.

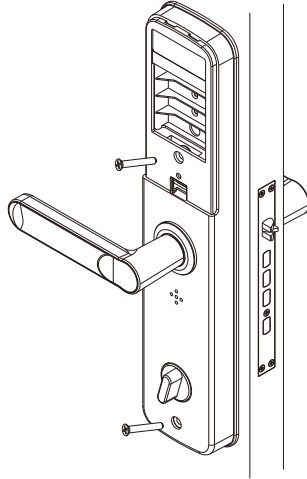

Install batteries

1. Put 4*AA batteries on the batter pack.
2. Cover the battery cover.

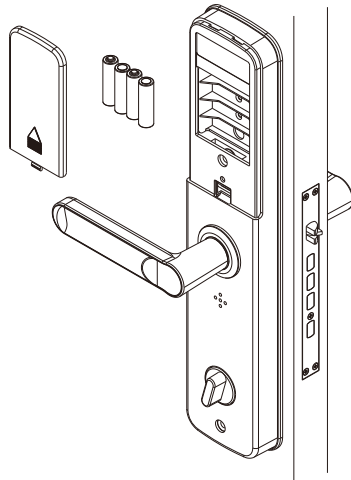

User Manual

1. Parameters:

Keys	Quantity	ID Range	Remark
Admin user	9	1-9	Fingerprint, key card, Code are able to be Admin user
Normal User	291	10-300	Fingerprint(Max 100pcs) , key card, Code are able to be Normal user

2. How to use:

A. Reset to the factory setting

Press the reset button on the rear body for 7 seconds, then release the reset button, you will hear a voice: successfully. Then all the information on the lock has been deleted, and the factory preset Master code will be changed back to 123456.

B. How to setup the lock

There are two ways to active the lock to enter the setup procedure.

1. Press the reset button on the rear body.
2. Touch keypad, then enter *+#

C. Add Admin user

1. Press the set button or Touch keypad, then enter enter *+#
2. Enter Admin User
3. You will hear a voice: 1.Add User, 2. Delete User, 3. Lock Setting, 4. Add Admin
4. Press "4" on the keypad, you will hear a voice: Add User.
5. Then register fingerprint, code or key card that you want to be the Admin
6. You will hear a voice: 001-009 successfully.

D. Delete Admin user

1. Press the reset button or Touch keypad, then enter enter *+#
2. Enter the Admin User
3. You will hear a voice: 1.Add User, 2. Delete User, 3. Lock Setting, 4. Add Admin
4. Press "2" on the keypad, you will hear a voice: Delete User.
5. Enter the ID of the Admin user+#
6. You will hear the ID and press # to confirm
7. You will hear a voice: successfully

E. Add normal users

1. Press the reset button or Touch keypad, then enter enter *+#
2. Enter the Admin User
3. You will hear a voice: 1.Add User, 2. Delete Users, 3. Lock Setting, 4. Add Admin
4. Press "1" on the keypad, you will hear a voice: Add User.
5. Then register fingerprint, code or key card that you want to be the normal users
6. You will hear a voice: 010-300 successfully

F. Delete one of the normal users

1. Press the reset button or Touch keypad, then enter enter *+#
2. Enter the Admin User
3. You will hear a voice: 1.Add User, 2. Delete User, 3. Lock Setting, 4. Add Admin
4. Press "2" on the keypad, you will hear a voice: Delete User.
5. Enter the ID of the Admin user+#
6. You will hear the ID and press # to confirm
7. You will hear a voice successfully

G. Delete all of the normal users at a time

1. Press the set button or Touch keypad, then enter enter *+#
2. Enter the Admin User
3. You will hear a voice:1.Add User, 2. Delete User, 3. Lock Setting, 4. Add Admin
4. Press "2" on the keypad, you will hear a voice: Delete User.
5. Enter 000 + #
6. Press # to confirm
7. You will hear a voice successfully

H. Lock configurations

1. Press the set button or Touch keypad, then enter enter *+#
2. Enter the Admin User
3. You will hear a voice: 1.Add User, 2. Delete User, 3. Lock Setting, 4. Add Admin
4. Press "3", you will hear a voice: 1.Function setting, 2. Volume setting , 3. Language setting, 4. Time setting.
5. Press "1"
6. There are 4 options on Function setting
 - ① Enable/disable Passage
 - ② Enable/disable Dual verify
 - ③ Enable/disable Anti burglar alarm
 - ④ Enable/disable mute
7. Please follow the voice guidance to configure the lock.

I. Volume setting

1. Press the set button or Touch keypad, then enter enter *+#
2. Enter the Admin User
3. You will hear a voice: 1.Add Users, 2. Delete Users, 3. Lock Setting, 4. Add Admin
4. Press "3", you will hear a voice: 1.Function setting, 2. Volume setting , 3. Language setting, 4. Time setting.
5. Press "2"
6. Press "1" to turn up volume, press"2" to turn down volume

J. language setting

1. Press the set button or Touch keypad, then enter enter *+#
2. Enter the Admin User
3. You will hear a voice: 1.Add Users, 2. Delete Users, 3. Lock Setting, 4. Add Admin
4. Press "3", you will hear a voice: 1.Function setting, 2. Volume setting , 3. Language setting, 4. Time setting.
5. Press "3"
6. Press "1" to Chinese, press"2" to English

K. Time setting

1. Press the set button or Touch keypad, then enter enter *+ #
2. Enter the Admin User
3. You will hear a voice: 1.Add Users, 2. Delete Users, 3. Lock Setting, 4. Add Admin
4. Press “ 3”, you will hear a voice: 1.Function setting, 2. Volume setting , 3. Language setting, 4. Time setting.
5. Press “4”

Please follow the voice guidance to configure the lock.